



Weymouth Railway Station and Associated Rail Heritage Sites
Interpretation design, manufacture and installation
Stage 3 CONTENT DOCUMENT 13/04/22

Smith and Jones
Design Consultants
www.smithandjones.co.uk

Organising the content across the sites

1. The station

A story of the station and the town, the visitors, the day trippers, the holiday makers. The history of the station and arriving at Weymouth. Waiting for a train, tickets, luggage, long journeys, experiences, memories, excitement, discovery.

2. The track

A story of the track coming into Weymouth, and links to other destinations around the country where the trains might have come from and where they might be going. We will present concept of the trains bringing in people, goods and therefore income to Weymouth.

3. The loop

A story of the loop and why it was added, the curve of the track and the turning circle of the trains. The loop allowed industry to bring in and send out goods. Images of the goods will be displayed, broccoli and tomatoes for example, with images of the wooden crates, storage units, warehouses and lumber yards.

4. The quay

A story of the drama and spectacle of trains coming into this area and trying to access the ferry port. Tight spaces, cars parked in the way, people with flags, sitting at the pub watching. Interpretation will capture a sense of this drama!

The port (for the future)

We understand the port location has been removed from the plan because the area is potentially going to be re-developed. This area tells an important part of the story, one of ferries leaving for the Channel Islands and ships with goods. To be discussed with you.



The same trail map at each location will encourage visitors to explore the other interpretation as part of a trail concept.

The concept - materials

The structures can be either single or double sided dependent on the location. The main structure to be galvanized finish so its hard wearing in a coastal location.

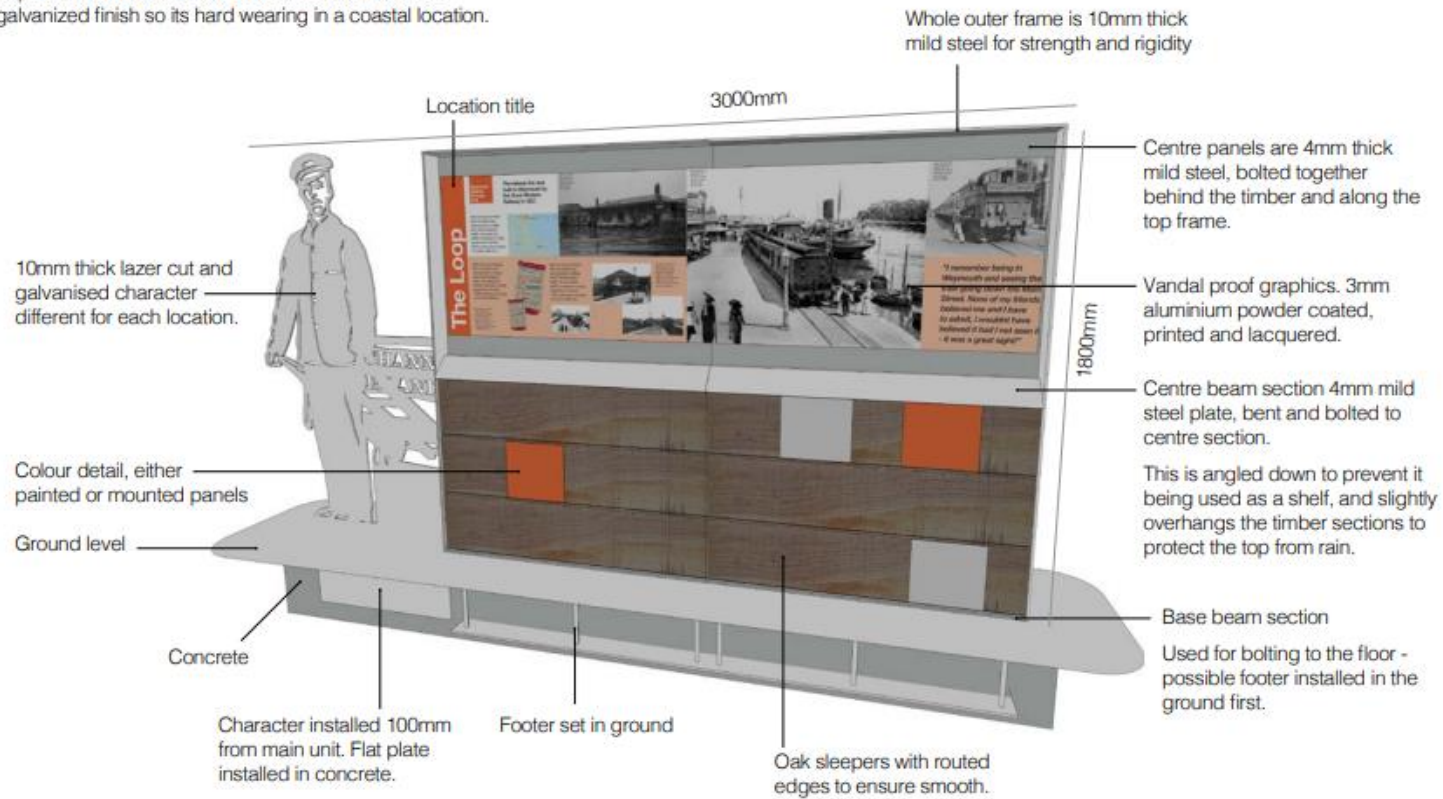

Fixings - overview

This is a cross section of the structure showing the footer and illustrated character installed into the ground by the council team. Process is cut the existing surface neatly, excavate, set in footer and character, fill with concrete ensuring all level.

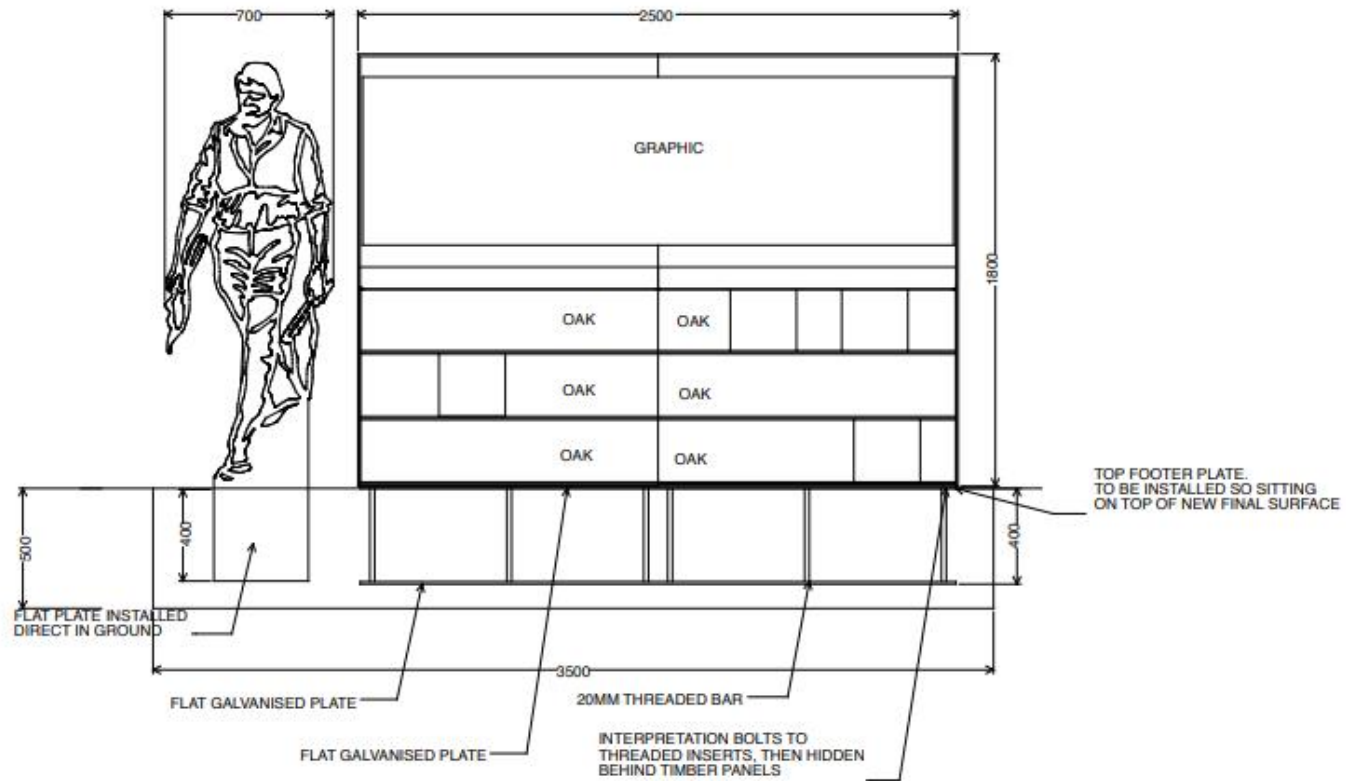

Fixings - footer

The council team to cost the installation of footers and character illustrations for 4 locations.

The top plate of the footer is to sit flush on top of the final finished surface, providing a 10mm detail at the bottom of the sign.

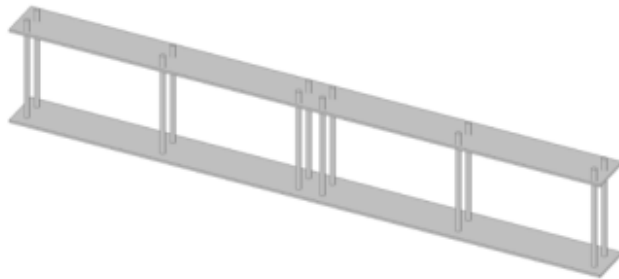

The Track, The Loop, The Quay all use 2500mm wide footers.



The Station uses 3 x 1000mm wide individual footers